

These drawings and specifications are the property of H2W Technologies, Inc. They are issued in confidence and shall not be reproduced, copied, or used without written permission from H2W Technologies, Inc. (www.h2wtech.com)

REVISION TABLE

REV	ECN#	DESCRIPTION	REV BY	APPROVED	DATE
---	---	Original Drawing	OOG	MPW	8-1-13

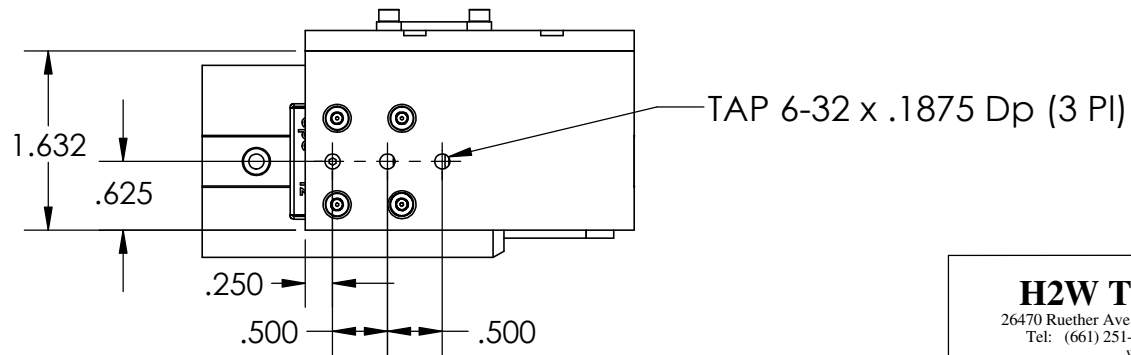
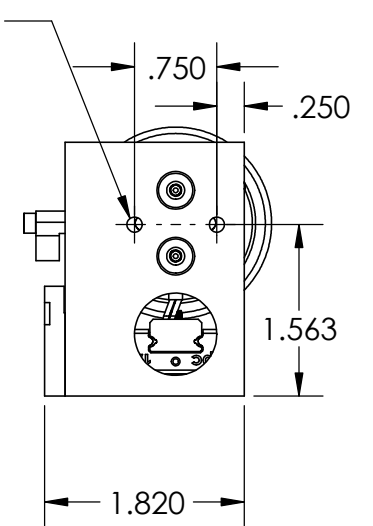
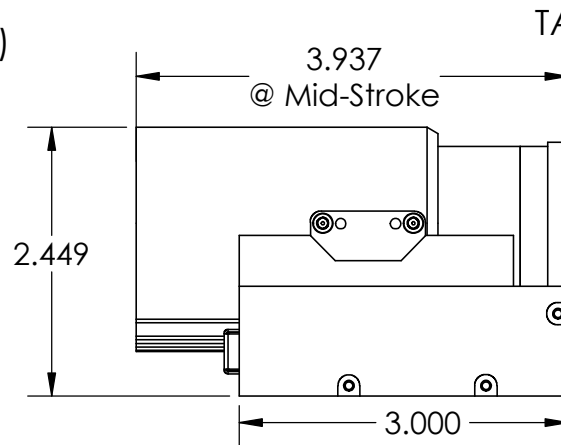
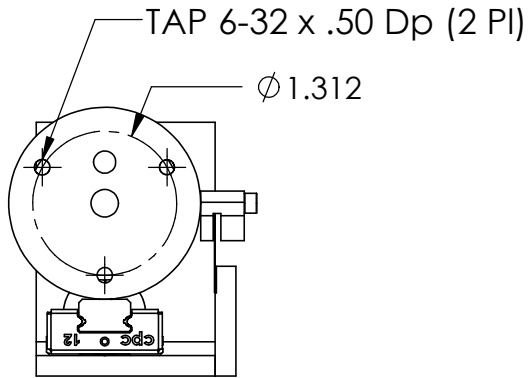
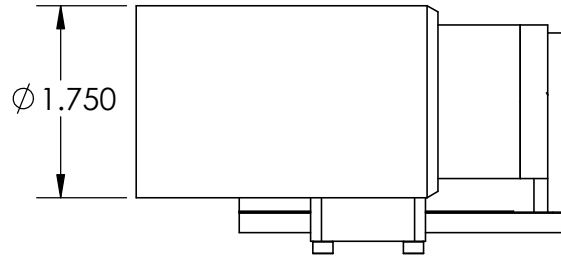

H2W Technologies, Inc.
 26470 Ruether Ave #102 Santa Clarita, CA 91350 USA
 Tel: (661) 251-2081 Fax: (661) 251-2067
 www.h2wtech.com

UNLESS SPECIFIED OTHERWISE:
 All dimensions are in inches
 Standard Tolerances are as follows
 .XXX ±.005 ANGLES ±1°
 .XX ±.010 FILLETS .010
 .X ±.020 CORNERS .010
 Remove All Burs and Sharp Edges

MATERIAL		DATE		APPROVED	
		8-1-13	MPW	8-1-13	
FINISH		DATE		APPROVED	
DRAWN	DATE	APPROVED	DATE	DWG #	REV
OOG	8-1-13	MPW	8-1-13	31-0648	---

TITLE		
Voice Coil Positioning Stage Model #: VCS20-020-LB-12		
DWG #	REV	SHEET
31-0648	---	1 of 2

VOICE COIL POSITIONING STAGE SPECIFICATIONS		
Motor P/N	NCC20-18-020-1X	
Stroke	0.20in	5.1mm
Encoder Resolution	12 micron	
Bearing Type	Linear Bearing	
Moving Mass	1.40 lbs	635 grams
Total Mass	1.95 lbs	885 grams
Resistance @ 20C	2.1 ohms	
Inductance @ 20C	160 μ H	
Electrical Time Constant	76 μ sec	
Motor Constant	0.26 LBS/SQRT(Watt)	1.17 N/SQRT(Watt)
Force Constant	0.39 LBS/Amp	1.71 N/Amp
Back EMF	0.04 V/ips	1.71 V/m/sec
Continuous Force	0.26 LBS	1.16 N
Max Power @ 100% Duty	1 Watt	
Peak Force	0.78 LBS	3.50 N
Max Power @ 10% Duty	9 Watts	

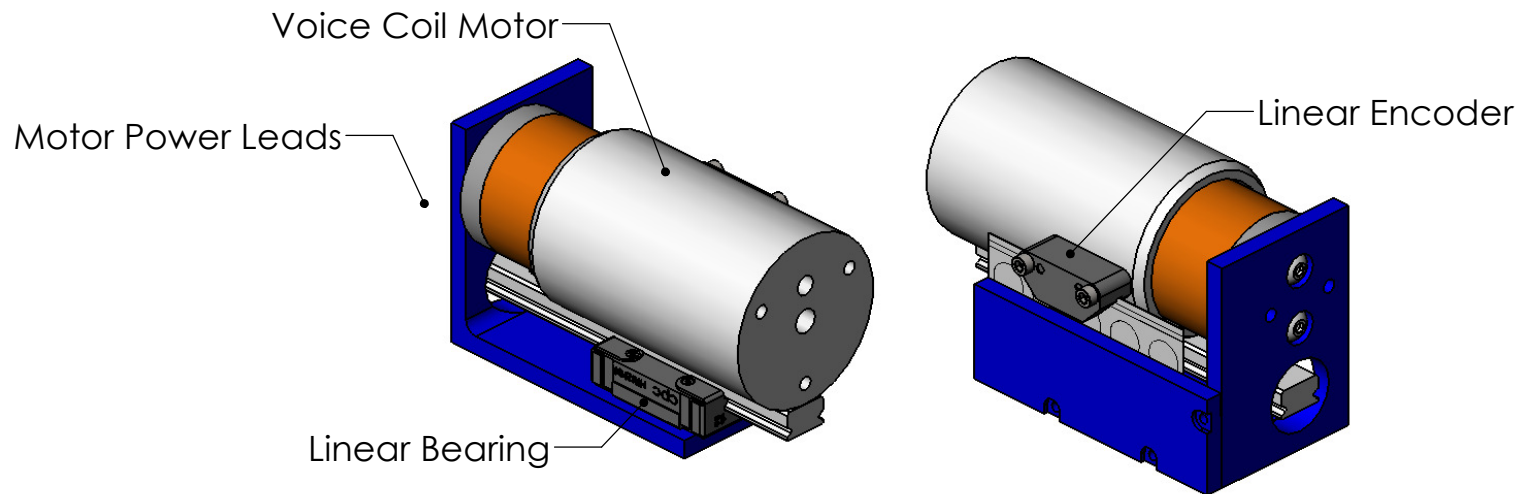

TITLE	Voice Coil Positioning Stage Model #: VCS20-02-LB-12		
DWG #	31-0648	REV	---
		SHEET	2 of 2